

Location and General topography  
 South Cooper Mountain High School, Beaverton, Oregon  
 (USGS - The National Map Viewer, 2014 Beaverton Oregon Quadrangle)

FIGURE  
 1

5503  
 9/18/14  
  
 Pacific Habitat Services, Inc.  
 9450 SW Commerce Circle, Suite 180  
 Wilsonville, OR 97070

SECTION 6 T2S R1W W.M.  
WASHINGTON COUNTY OREGON  
SCALE 1"=400'

2S 1 6

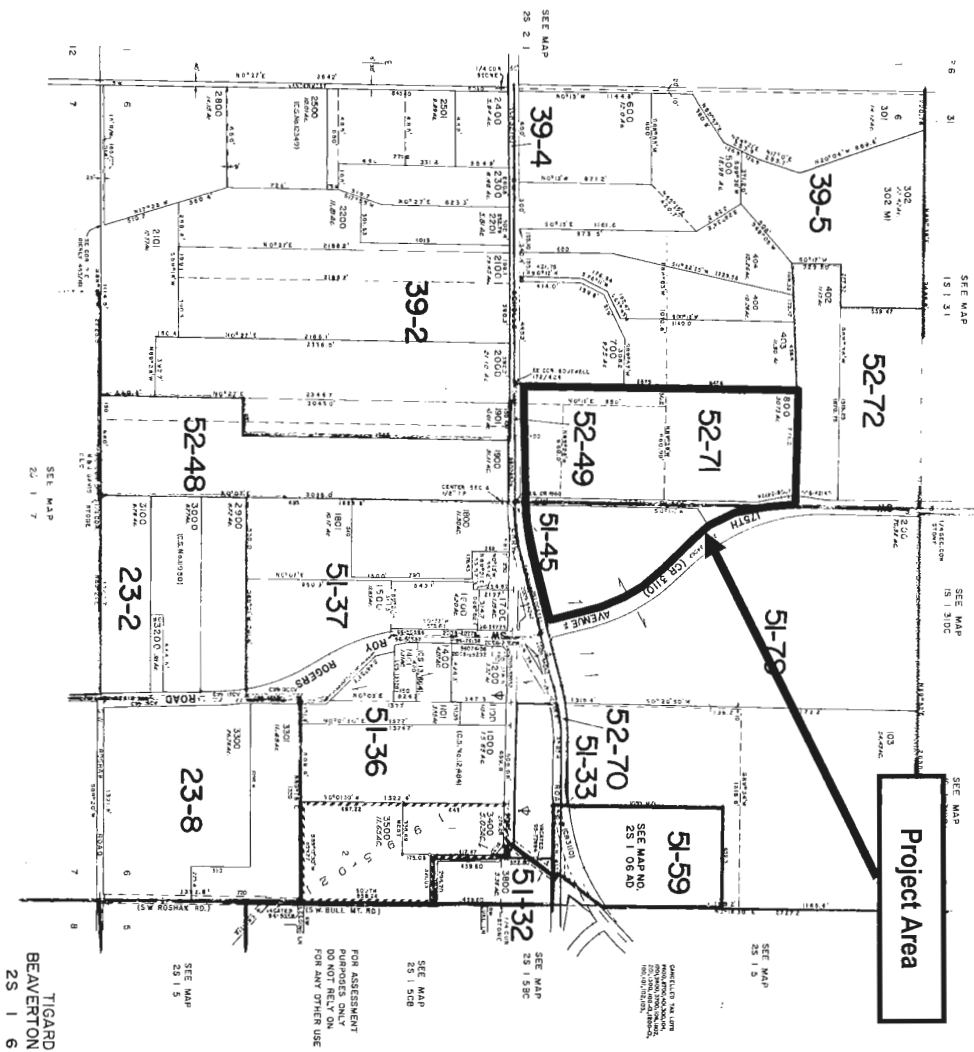

5503  
9/18/14  
Pacific Habitat Services, Inc.  
9450 SW Commerce Circle, Suite 180  
Wilsonville, OR 97070

Tax Lot map 2S 1W Section 6 Tax Lot 800 and Portion of Tax Lot 200, Washington County South Cooper Mountain High School, Beaverton, Oregon (ormap.net, 2014)

FIGURE  
2



5503  
9/18/14  
PHS  
Pacific Habitat Services, Inc.  
9450 SW Commerce Circle, Suite 180  
Wilsonville, OR 97070

Aerial photo  
South Cooper Mountain High School, Beaverton, Oregon  
(Google Earth, 2014)

FIGURE  
3

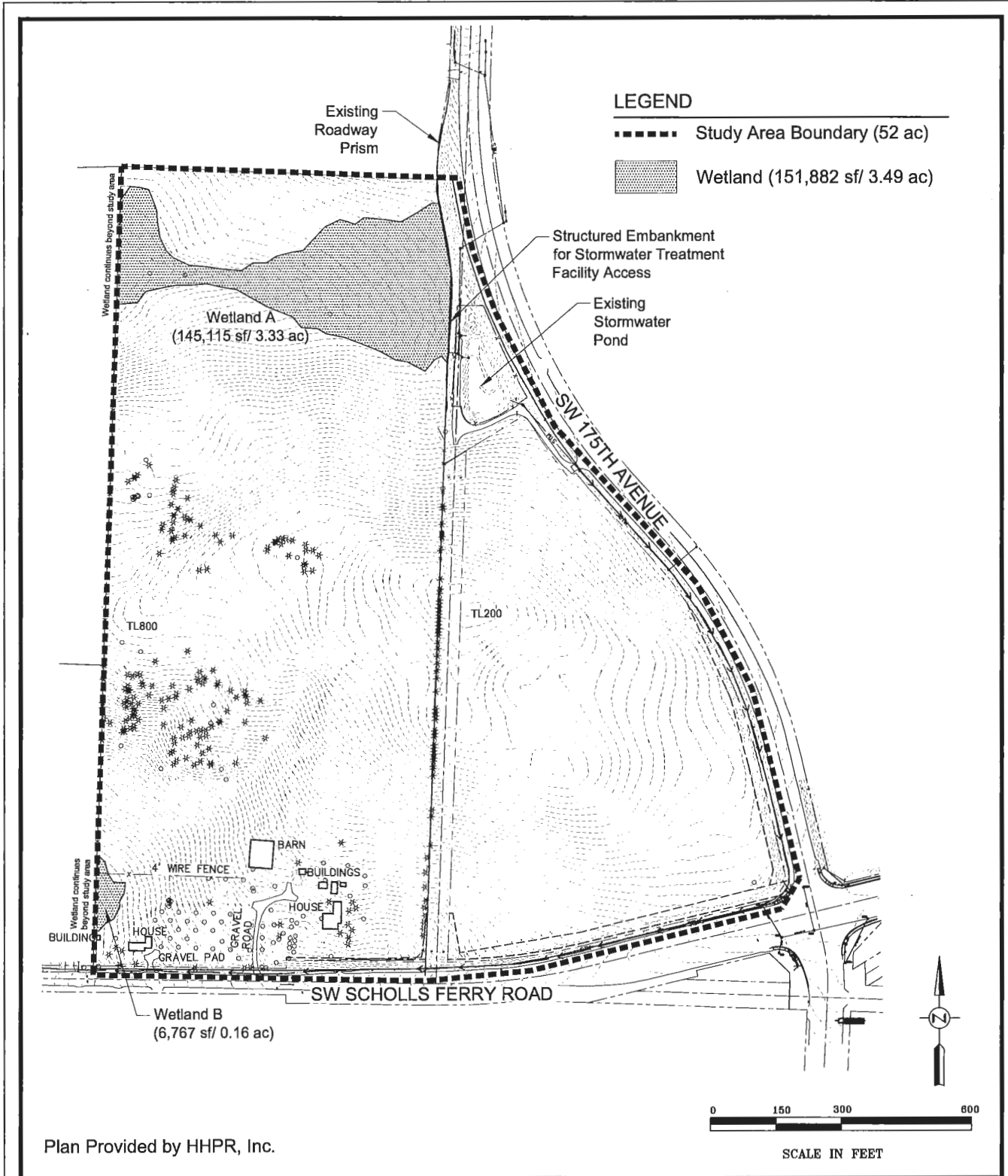

Existing Conditions

South Cooper Mountain High School - Beaverton, Oregon

**FIGURE**

**4**

2-06-2015

X:\Project Directories\5500\5503 Beaverton School District\AutoCAD\PlotDwgs\JPA Figures\Fig4 ExistCond.dwg, 2/10/2015 4:42:17 PM, CutePDF Writer

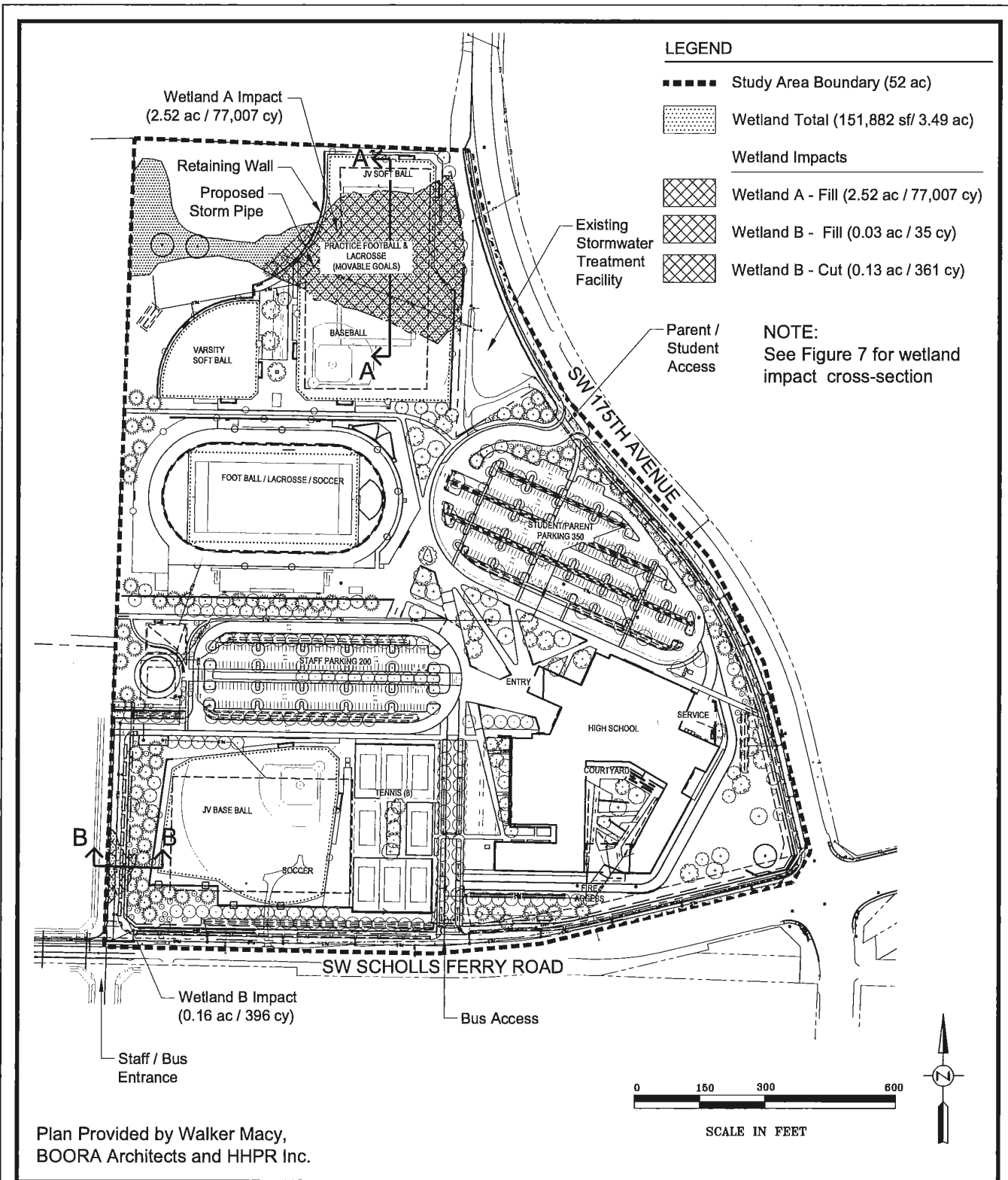



**PHS**  
Pacific Habitat Services, Inc.  
9450 SW Commerce Circle, Suite 100 Wilsonville, Oregon 97170  
Phone: (503) 670-0800 Fax: (503) 670-0855

Site Plan and Wetland Impacts and Cross Section Locations  
South Cooper Mountain High School - Beaverton, Oregon

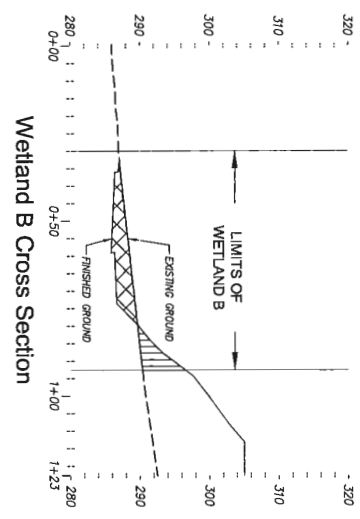
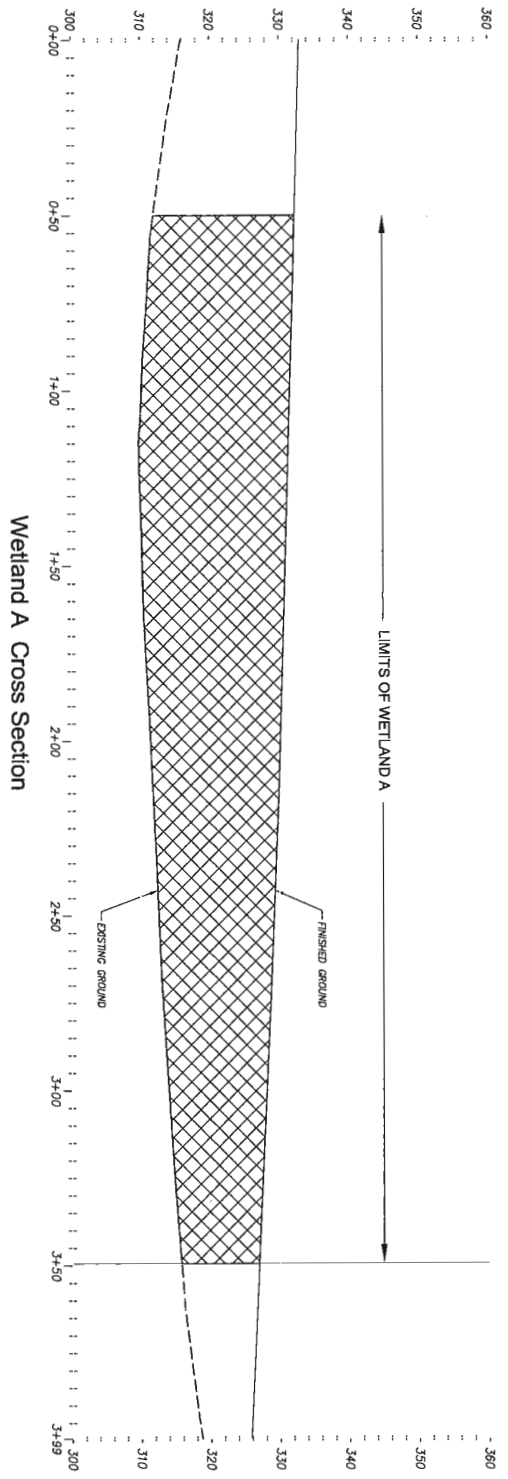
**FIGURE**  
**5**  
02-06-2015



- Wetland Impacts (Permanent)
-  Wetland A (77,077 cy of fill)
  -  Wetland B - (35 cy of fill)
  -  Wetland B - (361 cy of cut)

NOTE:  
See Figure 5 Site Plan for  
Cross Section Locations

Plan Provided by Walker Macy



**PHS**  
Pacific Habitat Services, Inc.  
5405 SW Commercial Park, Suite 100, Beaverton, Oregon 97008  
Phone: (503) 570-6800 Fax: (503) 570-6855

Wetland Impact Cross Section A-A and B-B  
South Cooper Mountain High School - Beaverton, Oregon



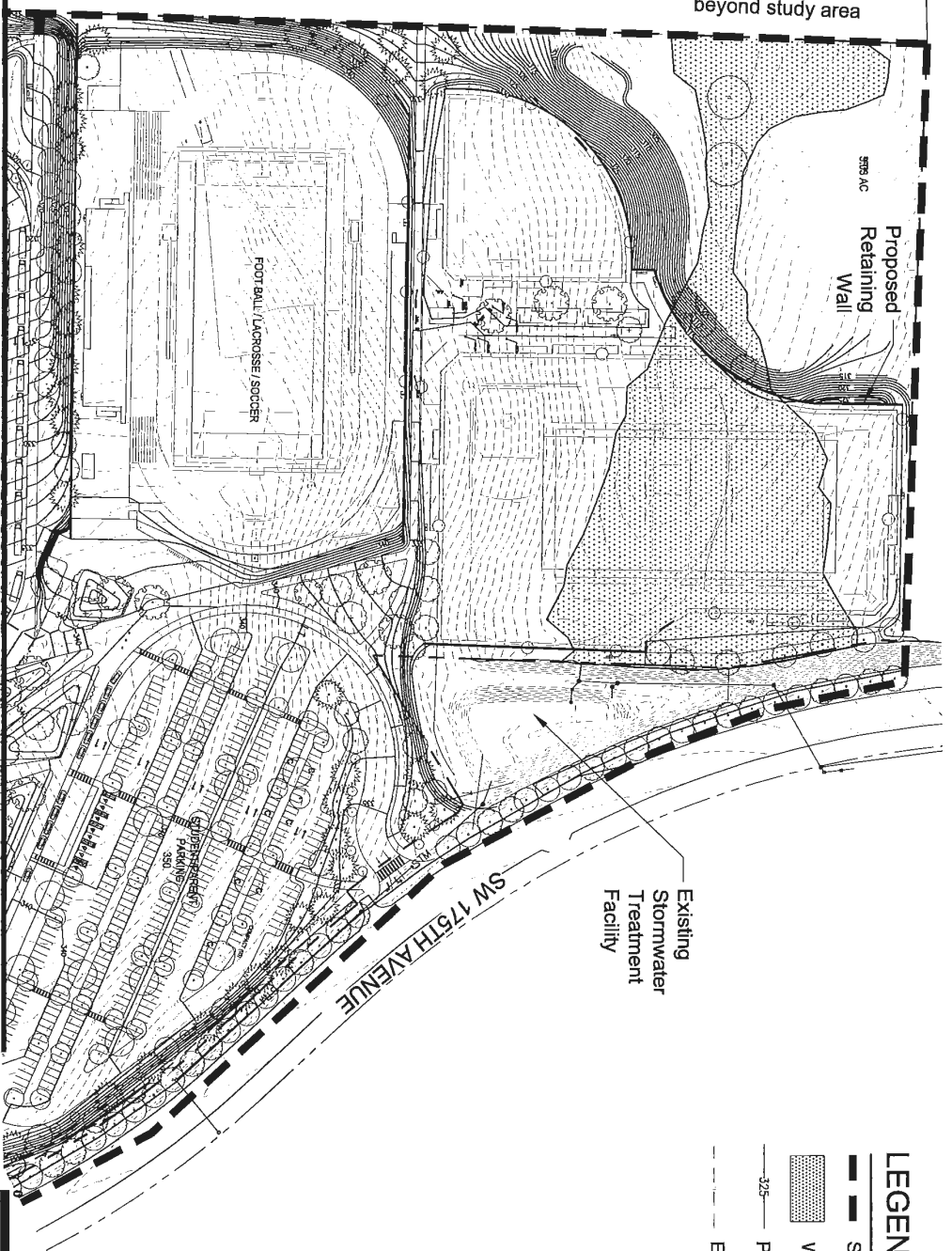

**FIGURE**  
**7**

02-06-2015

Wetland continues beyond study area



**LEGEND**

-  Study Area Boundary (52 ac)
-  Wetland (151,882 sft/ 3.49 ac)
-  Proposed Contour
-  Existing Contour

Plan Provided by Walker Macy,  
BOORA Architects and HPR Inc.



**Pacific Habitat Services, Inc.**  
9450 SW Commerce Crk., Suite 100 Wilsonville, Oregon 97070  
Phone: (503) 570-0800 Fax: (503) 570-0855

Proposed Grading Plan (North)  
South Cooper Mountain High School - Beaverton, Oregon

**FIGURE 8A**

02-06-2015

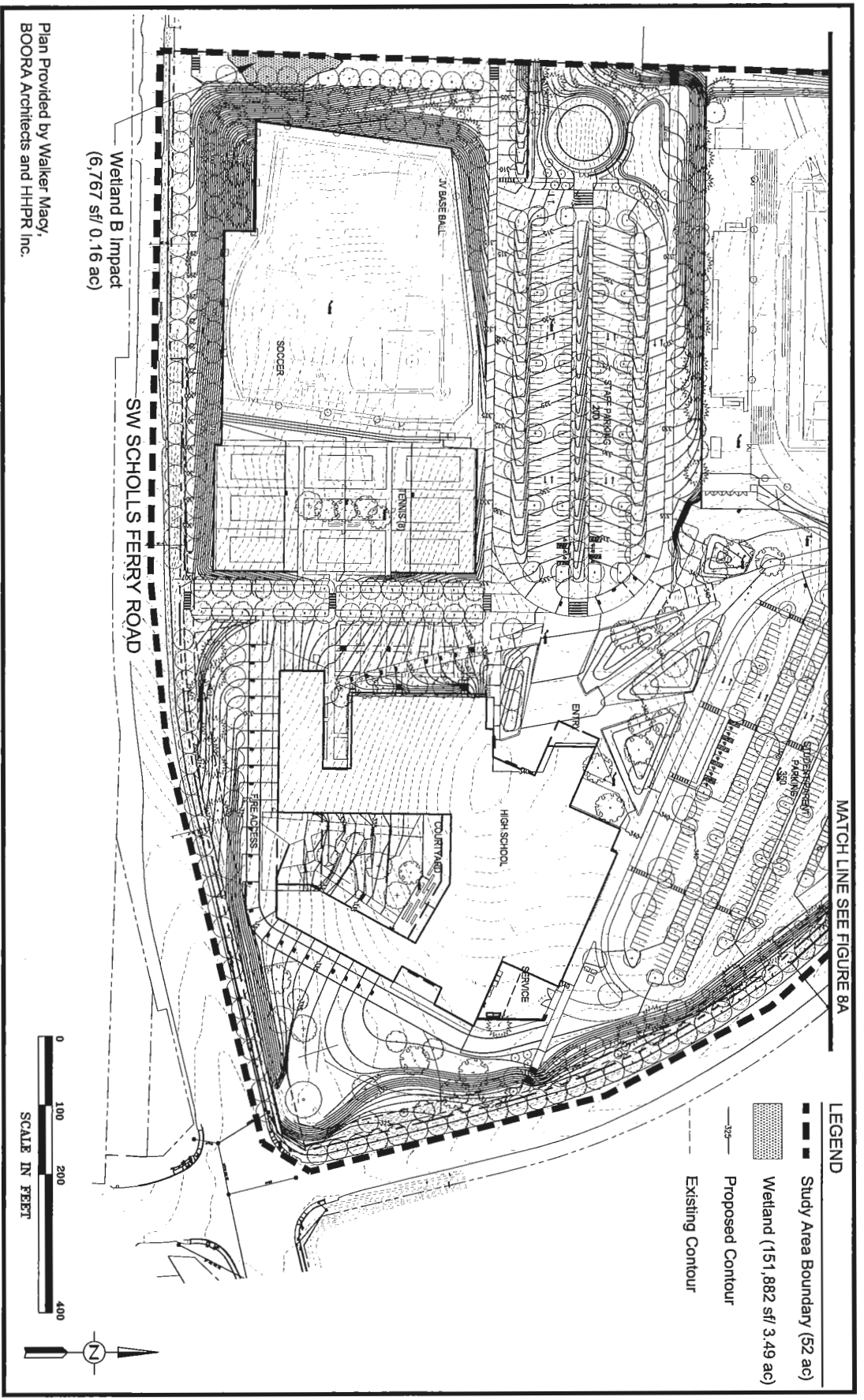

Plan Provided by Walker Macy,  
BOORA Architects and HPRP, Inc.

Wetland B Impact  
(6,767 sfl/ 0.16 ac)

SW SCHOLLS FERRY ROAD

MATCH LINE SEE FIGURE 8A

- LEGEND**
- Study Area Boundary (52 ac)
  - Wetland (151,882 sfl/ 3.49 ac)
  - Proposed Contour
  - Existing Contour

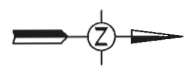
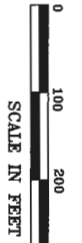

**Pacific Habitat Services, Inc.**  
9459 SW Commercial Drive, Suite 100, Milwaukie, Oregon 97131  
Phone: (503) 570-0800 Fax: (503) 570-0855

Proposed Grading Plan (South)  
South Cooper Mountain High School - Beaverton, Oregon

**FIGURE 8B**

02-06-2015



Plan Provided by Walker Macy,  
BOORA and HPR Inc.

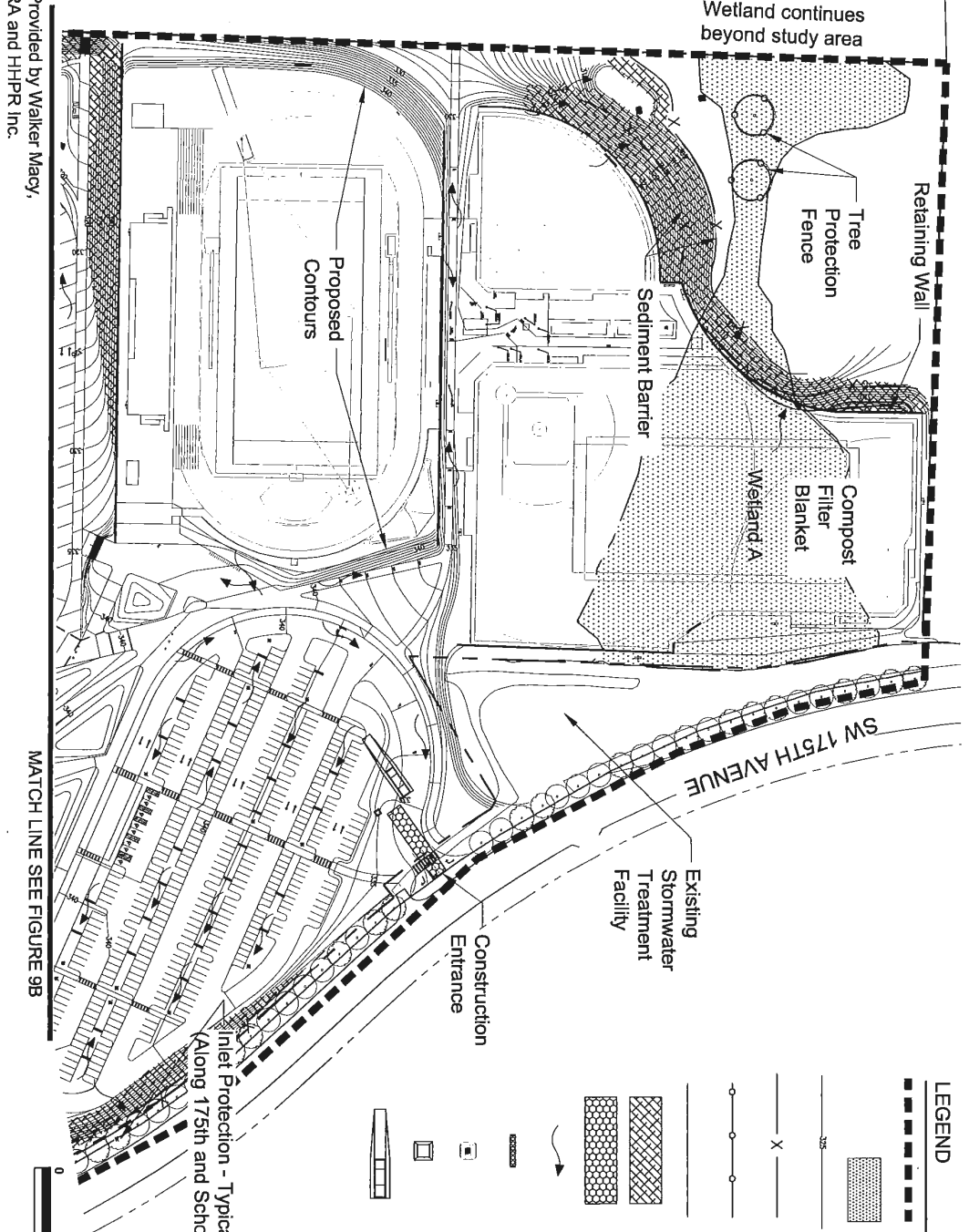

MATCH LINE SEE FIGURE 9B

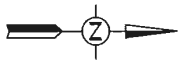
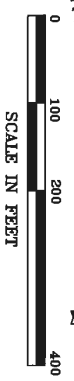

**LEGEND**

- Study Area Boundary (52 ac)
- Wetland (151,882 sf/ 3.49 ac)
- Proposed Contour
- COMPOST FILTER SOCK
- SEDIMENT BARRIER
- TREE PROTECTION FENCE
- DIVERSION DIKE
- COMPOST FILTER BLANKET
- CONSTRUCTION ENTRANCE
- FLOW ARROW
- ROCK CHECK DAM
- INLET PROTECTION
- CONCRETE WASHOUT
- TIRE WASH
- STAGING AREA (See Figure 9B)



**PHS**  
Pacific Habitat Services, Inc.  
3645 SW Commerce Court, Suite 100, Milwaukie, Oregon 97131  
Phone: (503) 570-4800 Fax: (503) 570-4855

Erosion Control Plan (North)  
South Cooper Mountain High School - Beaverton, Oregon

**FIGURE 9A**

02-05-2015

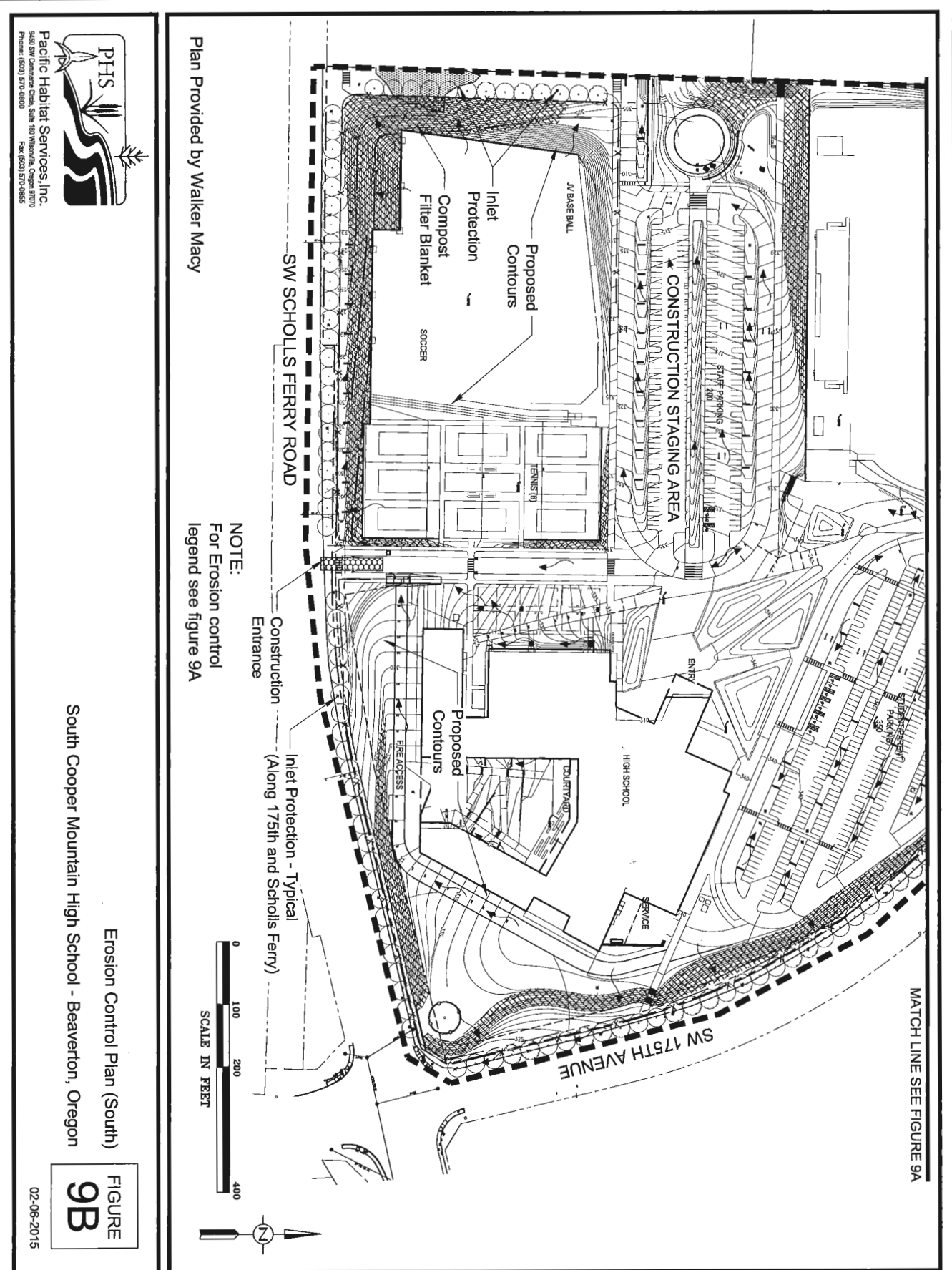

Pacific Habitat Services, Inc.  
3650 SW Commerce Court, Suite 100, Beaverton, Oregon 97005  
Phone: (503) 579-0000 Fax: (503) 579-0885

Erosion Control Plan (South)  
South Cooper Mountain High School - Beaverton, Oregon

FIGURE 9B  
02-06-2015

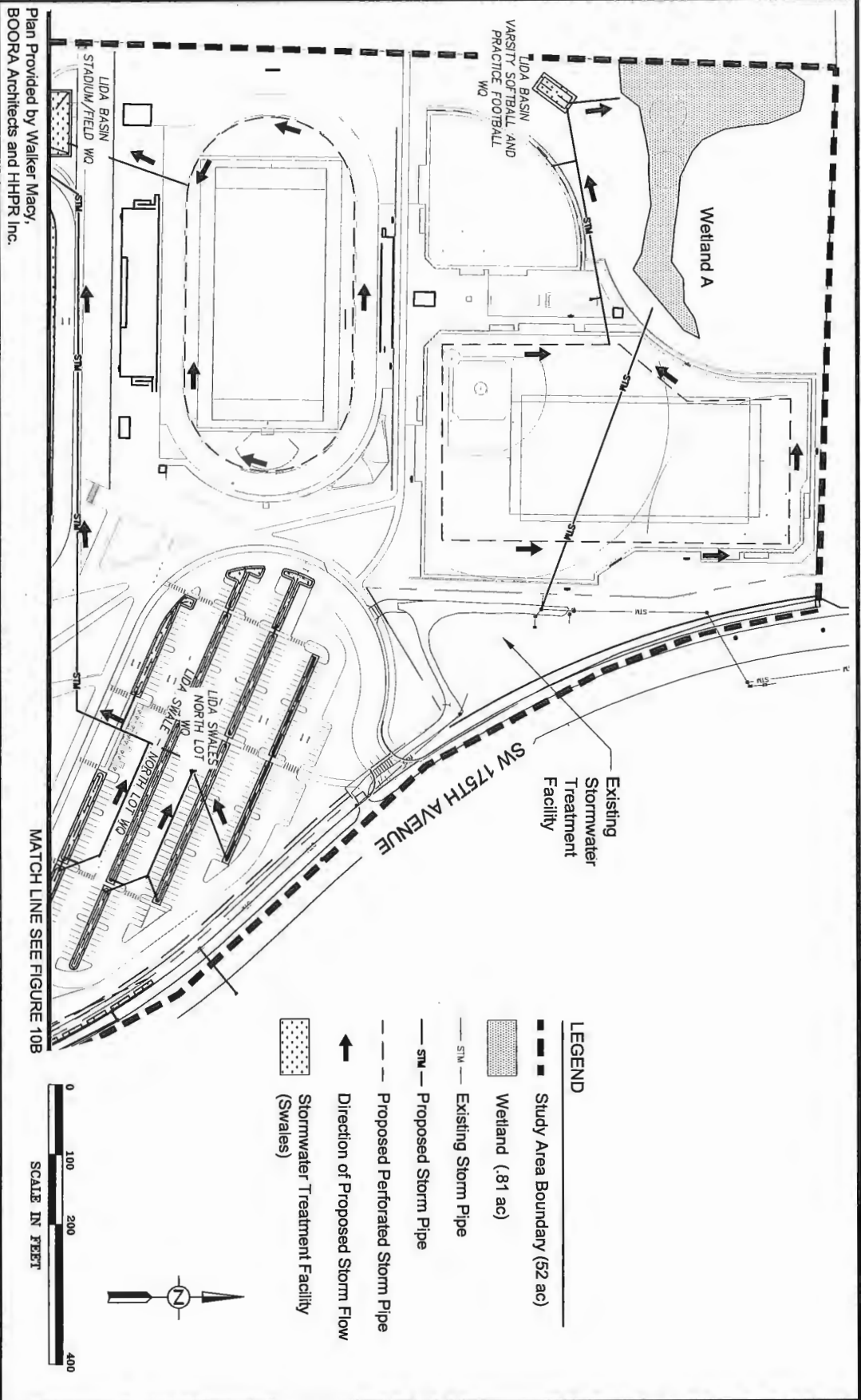

Plan Provided by Walker Macy,  
BOORA Architects and HHPR Inc.

MATCH LINE SEE FIGURE 10B

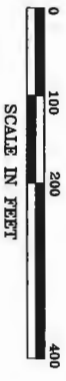

- LEGEND**
- Study Area Boundary (52 ac)
  - Wetland (.81 ac)
  - Existing Storm Pipe
  - Proposed Storm Pipe
  - Proposed Perforated Storm Pipe
  - Direction of Proposed Storm Flow
  - Stormwater Treatment Facility (Swales)



**Pacific Habitat Services, Inc.**  
3405 SW Commerce Court, Suite 100, Beaverton, Oregon 97005  
Phone: (503) 571-9888 Fax: (503) 571-9885

Proposed Stormwater Plan  
South Cooper Mountain High School - Beaverton, Oregon

**FIGURE 10A**

02-06-2015

MATCH LINE SEE FIGURE 10A

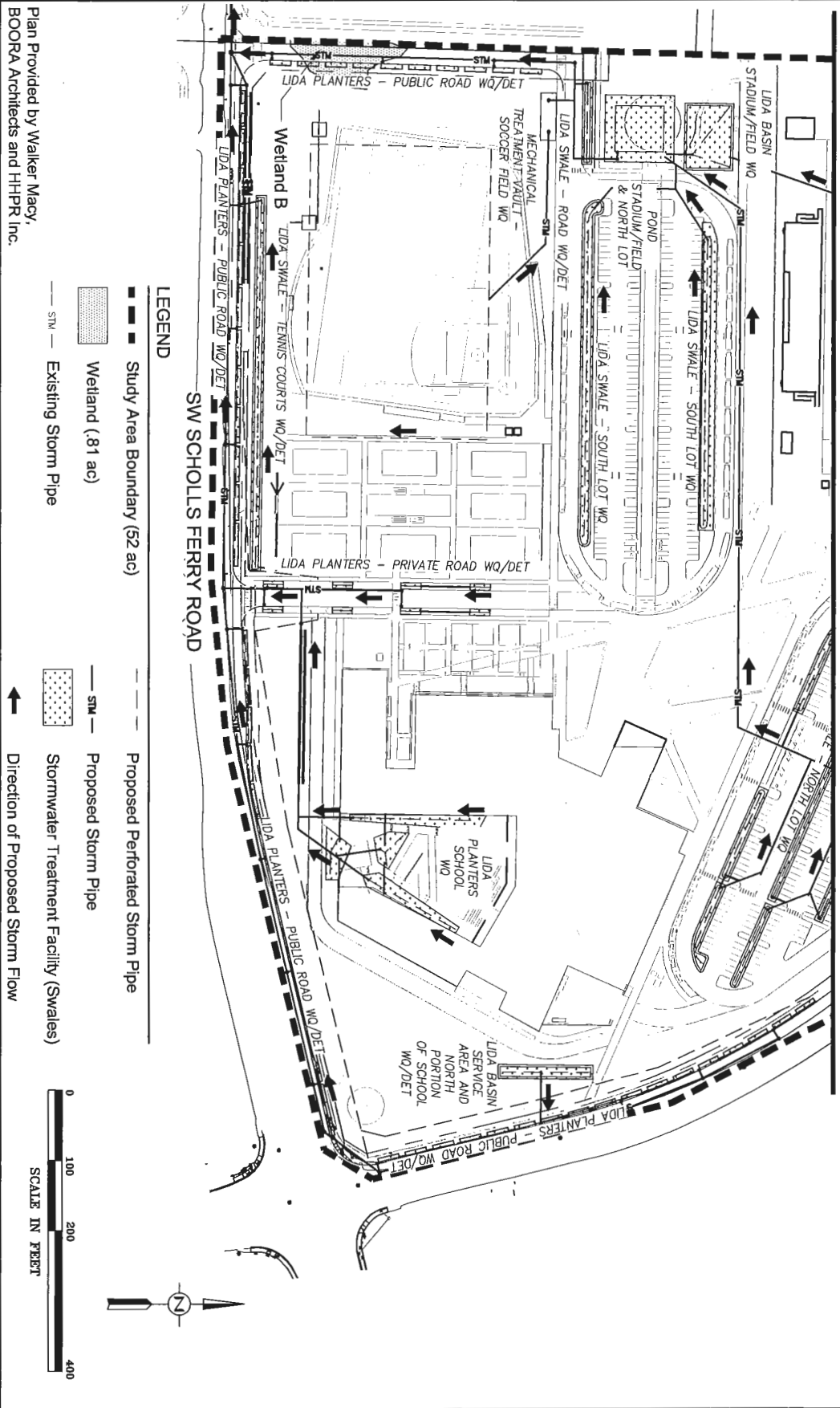

Plan Provided by Walker Macy,  
BOORA Architects and HHPR Inc.

- LEGEND**
- Study Area Boundary (52 ac)
  - ▨ Wetland (.81 ac)
  - Existing Storm Pipe
  - Proposed Perforated Storm Pipe
  - Proposed Storm Pipe
  - ▨ Stormwater Treatment Facility (Swales)
  - ➔ Direction of Proposed Storm Flow

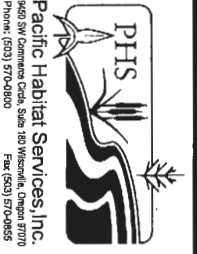
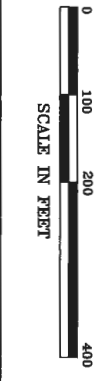

Proposed Stormwater Plan  
South Cooper Mountain High School - Beaverton, Oregon

**FIGURE 10B**

02-06-2015

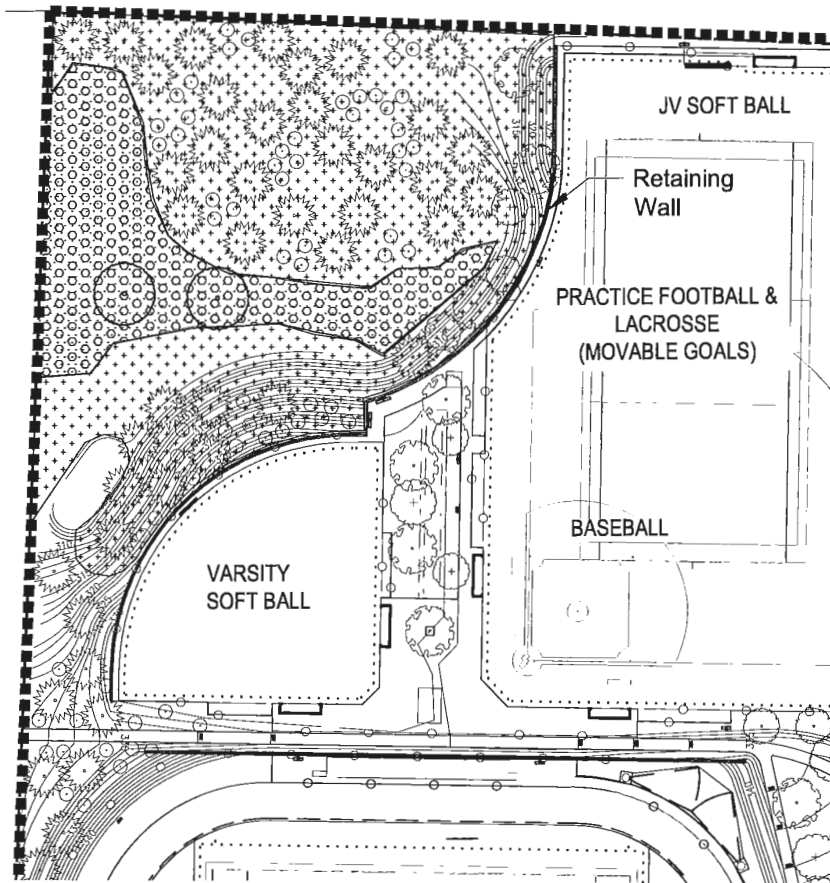

**LEGEND**

- Study Area Boundary (52 ac)
- ▤ Wetland
- ▨ Wetland Enhancement Area (0.81 ac)
- ★ Upland Buffer Restoration Area (2.62 ac)

NOTE:  
See Figure 11A for Plant Tables

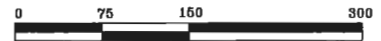

SCALE IN FEET



Site Plan Provided by Walker Macy,  
BOORA Architects and HHPR Inc.



Wetland Enhancement and Upland Restoration Plan  
South Cooper Mountain High School - Beaverton, Oregon

FIGURE  
**11**

02-06-2015

**Wetland Enhancement Area – 35,284 SF/0.81 AC**

Botanical Name	Common Name	Sizes (Height or gallon)	Planting density (on center)	Quantity
<b>Trees</b>				
<i>Fraxinus latifolia</i>	Oregon ash	3' or 2 gallon	10'	353
			<b>Total</b>	<b>353</b>
<b>Shrubs/Small Trees</b>				
<i>Salix scouleriana</i>	Scouler's willow	3' or 1 gallon	5'	441
<i>Spiraea douglasii</i>	Douglas spiraea	1.5' or 1 gallon	5'	441
<i>Rosa pisocarpa</i>	Clustered rose	1.5' or 1 gallon	5'	441
<i>Crataegus douglasii</i>	Black hawthorn	2' or 2 gallon	5'	441
			<b>Total</b>	<b>1,764</b>

**Upland Buffer Restoration Area – 114,127 SF/2.62 AC**

Botanical Name	Common Name	Sizes (Height or gallon)	Planting density (on center)	Quantity
<b>Trees</b>				
<i>Pseudotsuga menziesii</i>	Douglas fir	3' or 2 gallon	10'	760
<i>Acer macrophyllum</i>	Big leaf maple	3' or 2 gallon	10'	381
			<b>Total</b>	<b>1,141</b>
<b>Shrubs/Small Trees</b>				
<i>Symphoricarpos alba</i>	Snowberry	1.5' or 1 gallon	5'	1,427
<i>Mahonia aquifolium</i>	Holly leaf Oregon grape	6" or 1 gallon	5'	1,427
<i>Crataegus douglasii</i>	Black hawthorn	2' or 2 gallon	5'	1,426
<i>Polystichum munitum</i>	Swordfern	2 gallon	n/a	1,426
			<b>Total</b>	<b>5,706</b>



Wetland Enhancement and Upland Restoration Planting Table  
 South Cooper Mountain High School - Beaverton, Oregon

**FIGURE  
11A**  
 02-06-2015